

[otto a+d](#) [planet otto](#) [forum](#)
 [\(http://www.otto-otto.com\)](http://www.otto-otto.com) [\(http://planet.otto-otto.com\)](http://planet.otto-otto.com) [\(http://forum.otto-otto.com\)](http://forum.otto-otto.com)

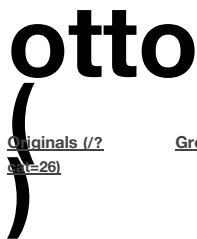

architecture + design

Search

[Originals](#) (/?cat=26) [Green](#) (/?cat=5) [Spaces](#) (/?cat=20) [Products](#) (/?cat=3) [Buzz](#) (/?cat=4)

[About](http://www.otto-otto.com/about/) [Advertise](http://www.otto-otto.com/advertise/) [Sign Up](http://www.otto-otto.com/sign-up/)

Payette Honored by CARITAS Project

July 12, 2010

[Payette](http://www.payette.com) has announced the firm's design of the 182,000 SF **Pennsylvania State University Hershey Medical Center Cancer Institute** was named the sole recipient of the inaugural **Generative Space Health Improvement Award** by the [CARITAS Project](http://www.thecaritasproject.info/). The Cancer Institute is located on the Penn State Milton S. Hershey Medical Center Campus in University Park, Pennsylvania and was formally dedicated in June 2009.

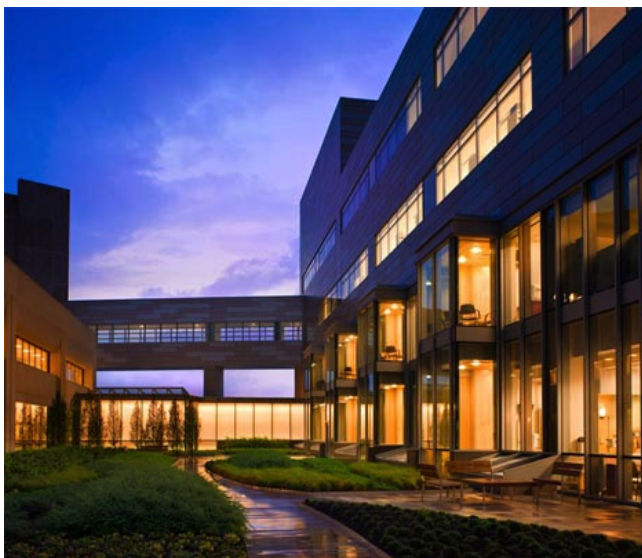

Sign up for otto updates

Email Address:

Subscribe

Sign up for otto updates

Email Address:

Subscribe



www.Groupon.com/Boston

Ads by Google

The CARITAS Project seeks to identify and recognize healthcare settings from around the world where the focus is on improving human health through improving the design of the environment, and as a result individuals, organizations, and communities flourish, and this annual international award recognizes projects that utilize the whole environment as a tool to improve healthcare.

Designed to provide patients and their families with a welcoming, peaceful environment while they receive the latest in advanced medical treatments, this cancer institute is an experiment in full translational medicine, where research and clinical functions are strategically mixed to encourage collaboration between the two. Clinical functions are located on the lower three floors, and research labs are located on the top two levels. Researchers and clinical doctors share offices on the top two floors, with ancillary support spaces located to encourage spontaneous encounters across groups. The keynote space is a five-story "beehive" atrium, which links all research and clinical floors and provides vertical and horizontal connections between the two groups.

Filed under [Awards](http://www.otto-otto.com/category/buzz/awards/), [Spaces](http://www.otto-otto.com/category/spaces/) and tagged [CARITAS Project](#)

Quality Of Healthcare

GE Research for Better Healthcare. Learn More at Healthymagination.com

Six Sigma Certification

100% Online Six Sigma Certification From Villanova. Save Up to 12% Now! www.VillanovaU.com/SixSigma

CARF Accreditation

Have our experienced Massachusetts based team assist your agency www.massbaysupportcenter.com